

Durable Lighting Made for Industrial Safety



Hazardous Location LED Luminaire STA1/STA2 Series

Specsheet-2024-06 EN

VOCARE
LED LIGHT



STA1

STA2



Product Description

The STA1/STA2 Series LED fixture is the ideal choice for marine and hazardous applications. They can be used in locations where moisture, dirt, dust, corrosion and vibration may be present, or areas where wind, water, snow or high ambient can be expected.

Features

- Suitable for Zone 1&2 (Gas), Zone 21&22 (Dust)
- High luminous efficacy - Up to 120-140 lumens per watt
- 0-10V dimming
- Waterproof and dust-proof, without internal cleaning and maintenance
- Simple structure for easy and quick installation
- Stainless steel fasteners, ADC12 aluminum housing, good corrosion resistance
- Tempered glass, high light transmittance and impact resistance

Compliance

ATEX Standard (Zone 1):

Ex II 2 G Ex eb mb IIC T6...T4 Gb

Ex II 2 D Ex tb IIIC T95°C...T125°C Db IP66

ATEX Standard (Zone 2&21&22):

Ex II 3G Ex ec mb IIC T6...T4 Gc

Ex II 2D Ex tb IIIC T80°C...T100°C Db

IECEx Standard (Zone 1):

Ex eb mb IIC T6...T4 Gb

Ex tb IIIC T95°C...T125°C Db IP66

IECEx Standard (Zone 2&21&22):

Ex ec mb IIC T6...T4 Gc

Ex tb IIIC T80°C...T100°C Db

Class I Zone 2 Group IIC

Class II Zone 21 Group IIIC

IP66

IK06/07 (without wire guard)

IK09 (with wire guard)

1000 hours salt spray

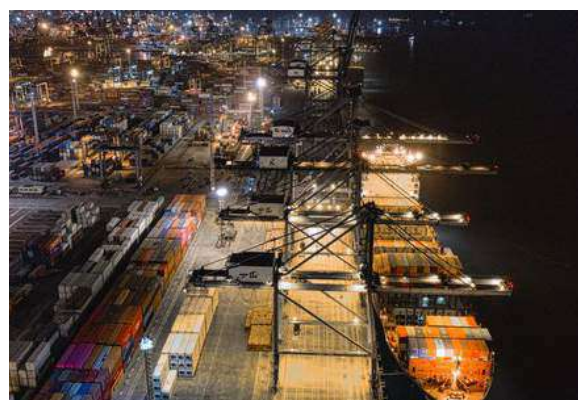

Application

- Power Plants
- Heavy Industrials Storage Facility
- Paper mills
- Wastewater Treatment Plants
- Loading Docks Platforms
- Offshore Environments
- Chemical Processing Facility
- Petrochemical Processing Facility
- Metallurgical Industry
- Coal Mine
- Food and Alcohol industry



Warranty

3 Year Standard Warranty

Technical Parameter

• Electrical

| Model | STA1 | STA2 |
|-----------------|----------------------------------------|--------------|
| Rated Power | Max. 120W/Max. 200W/Max. 240W | Max. 120W |
| Input Voltage | AC200-277V | AC200-277V |
| Input Frequency | 50/60Hz | 50/60Hz |
| Emergency | Emergency only for STA1 with Max. 120W | No emergency |

• Optical

| Model | STA1 | STA2 |
|-----------------|-------------------------------------------------|------------------------|
| Lumen Output | 14,400-16,800Lm/24,000-28,000Lm/28,800-33,600Lm | 14,400-16,800Lm |
| Lumens Per Watt | 120-140lm/W | 120-140lm/W |
| CCT | 2700K-7000K | 2700K-7000K |
| CRI | > 70 | > 70 |
| Beam Angle | 40°/60°/90°/120°/T3/T5 | 40°/60°/90°/120°/T3/T5 |
| Dimming | 0-10V dimming | 0-10V dimming |

• Mechanical

| Model | STA1 | STA2 |
|------------------|------------------------------------------------------------------|------------------------------------------------------------------|
| Housing Material | ADC12 aluminum | ADC12 aluminum |
| Glass | Tempered glass | Tempered glass |
| Surface | Explosion-proof joint surface | Explosion-proof joint surface |
| Fasteners | Stainless steel | Stainless steel |
| Protection | IP66/IP67 IK06/07 (without wire guard)/IK09 (with wire guard) | IP66/IP67 IK06/07 (without wire guard)/IK09 (with wire guard) |
| Mounting | Pole, Trunnion, Arm, Slip Fitter, Bracket, Stanchion | Pole, Trunnion, Arm, Slip Fitter, Bracket, Stanchion |

• Environmental

| Model | Rated Power | Ambient Temperature | Temperature Class (Gas/Dust) |
|------------------|-------------|---------------------|------------------------------|
| STA1 (Normal) | Max. 240W | -40°C to +40°C | T4/80°C |
| | Max. 200W | -40°C to +50°C | T4/90°C |
| | Max. 120W | -40°C to +40°C | T5/80°C |
| | Max. 120W | -40°C to +56°C | T5/90°C |
| | Max. 120W | -40°C to +66°C | T4/90°C |
| STA1 (Emergency) | Max. 120W | 0°C to +40°C | T4/80°C |
| STA2 | Max. 100W | -40°C to +40°C | T5/80°C |
| | Max. 100W | -40°C to +50°C | T5/80°C |
| | Max. 100W | -40°C to +56°C | T4/90°C |
| | Max. 50W | -40°C to +40°C | T6/80°C |
| | Max. 50W | -40°C to +66°C | T5/90°C |

Product Dimensions (Unit: mm)

STA1

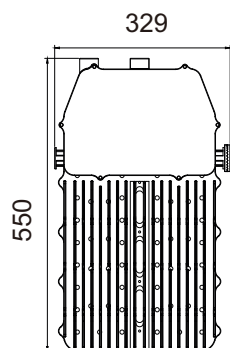

72

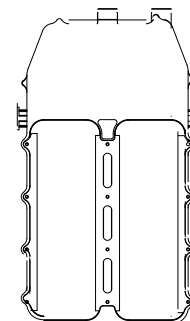

STA2

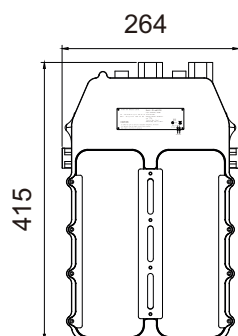

75

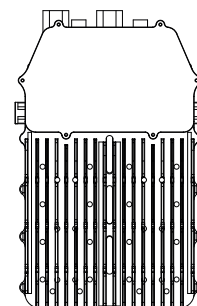
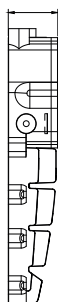

• Packing Information

| Model | Net Weight (Product) | Product Dimensions (LxWxH) | Quantity/Carton | Gross Weight | Package Dimensions (LxWxH) |
|-------|----------------------|---------------------------------------|-----------------|----------------|----------------------------------------|
| STA1 | 9.5kg/20.94lb | 550x329x72mm/ 21.65x12.95x2.83inch | 1 pc | 10.5kg/23.15lb | 692x388x125mm/ 27.24x15.27x4.92inch |
| STA2 | 6.5kg/14.33lb | 415x264x75mm/ 16.34x10.39x2.95inch | 1 pc | 7.5kg/16.53lb | 560x320x127mm/ 22.05x12.60x5.00inch |

Photometric

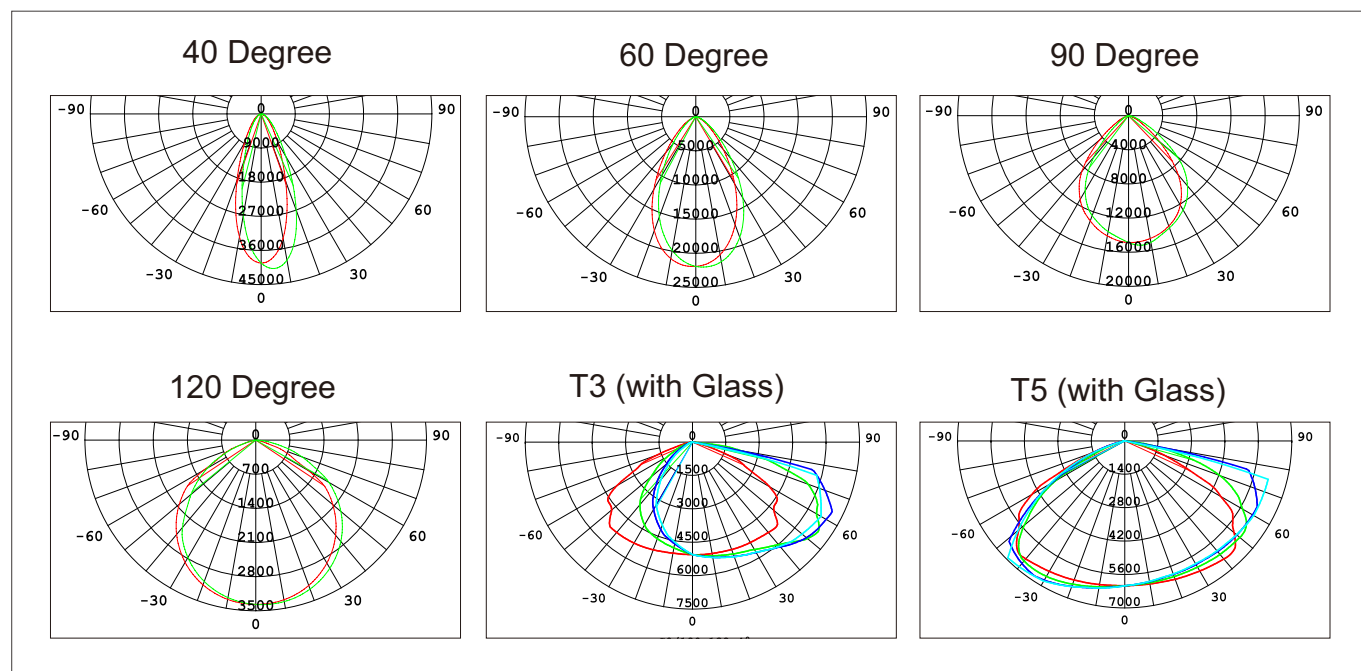

Ordering Guide (for Zone 2)

EX -
 ***W

*
**
D***
*
-2

1 2 3 4 5 6 7 8

| 1. Product Type | 2. Luminaires Wattage | 3. Product Code | 4. Dimming Option |
|------------------------------------------------------------------------------------|--------------------------------------------------------------------|--------------------------------------------------------------------------|------------------------------|
| EX: explosion proof light | for STA1: Max. 120W/Max. 200W/ Max. 240W for STA2: Max. 120W | STA1 STA2 | D=Dimmable N=Non-dimmable |
| 5. Color Temperature (CCT) | 6. Beam Angle | 7. Emergency Power | 8. Zone |
| 27=2700K, 30=3000K, 40=4000K 45=4500K, 50=5000K, 55=5500K 60=6000K, 65=6500K | D120=120° | -EM: with emergency power [#] Blank: without emergency power | -2: Zone 2 |

Remark: [#] Only for product code STA1 with Max. 120W

Mounting Methods and Accessories

• Option1: Pole Mounting

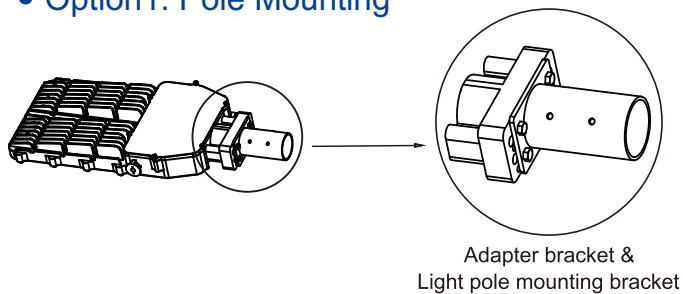

• Accessories

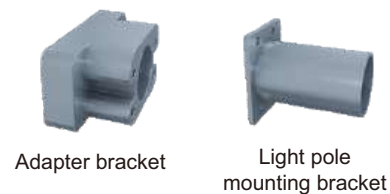

• Option 2: Trunnion Mounting

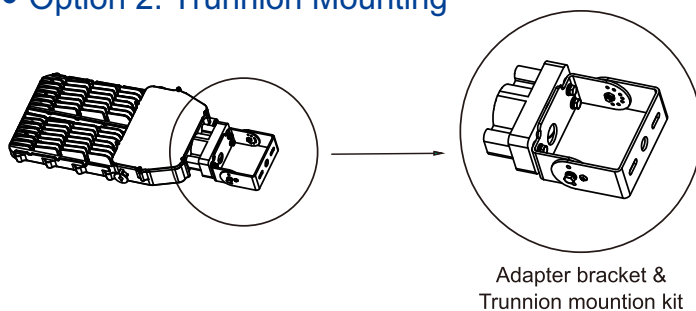

• Accessories

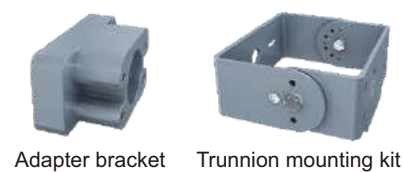

• Option 3: Arm Mounting (A)

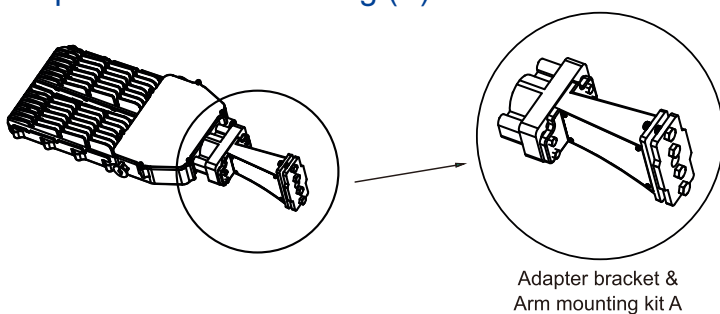

• Accessories

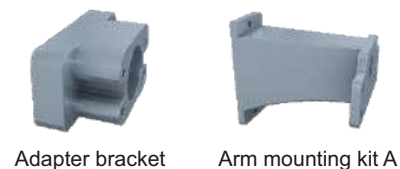

• Option 4: Arm Mounting (B)

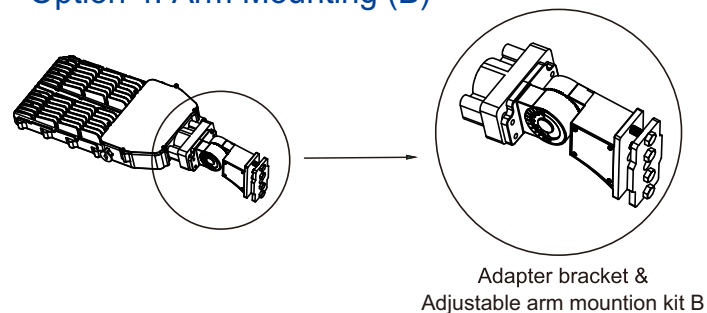

• Accessories

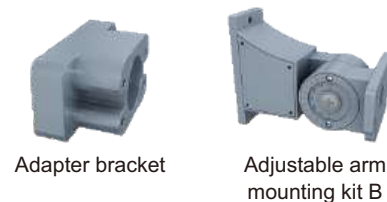

Mounting Methods and Accessories

• Option 5: Slip Fitter Mounting

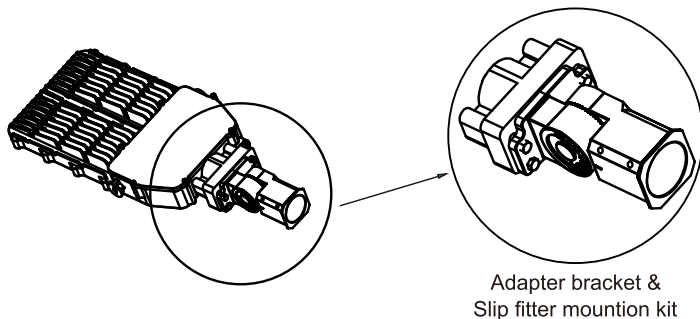

• Accessories

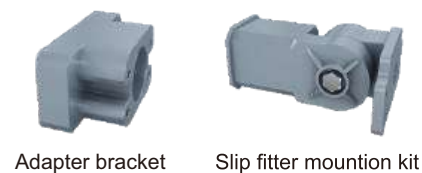

• Option 6: Bracket Mounting

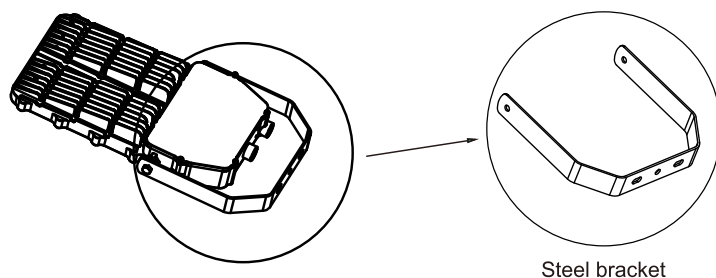

• Accessory

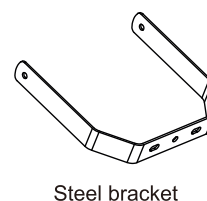

• Option 7: Trunnion Mounting

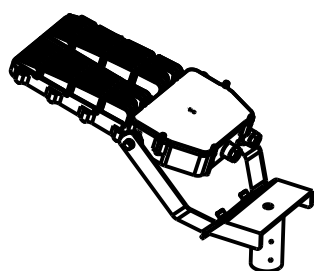

• Accessory

